



RF Components

Model Number:
WGLX-XXXX-197179-XX

X-Band Waveguide Load

7.05 - 10.00 GHz

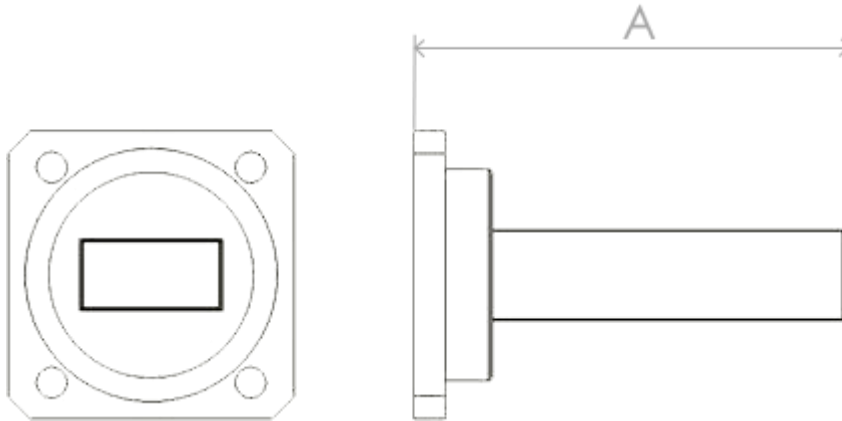

Specification	
Waveguide Size	WG15 / WR112 / R84
Flanges	CPR 112F (CF) / CPR 112G (CG) / UG51/U (UF) / UG52B/U (UG) / UG51/U (US) / UBR84 (UB) / PBR 84 (PB) / PDR 84 (PD) / CBR 84 (CB) / UDR 84 (UD)
Flange Material/Finish	Brass (B) / Aluminium (A)
Frequency Range	7.05 - 10.00 GHz
Length (A)	150mm
VSWR / Return Loss	1.02 :1 / 40 dB
Power Handling	5W

Model Numbers Example WGLA-0005-197179-PB				
WGL	A	0005	197179	CG
Waveguide Load / Termination	A—Aluminium B— Brass	Power Handling (W)	Model Number	Waveguide Flange

Broadcast



Marine Oil & Gas



SNG & VSAT



Satellite Teleport

